

019 INTERMEDIATE PIVOT 1 1/2" OFFSET

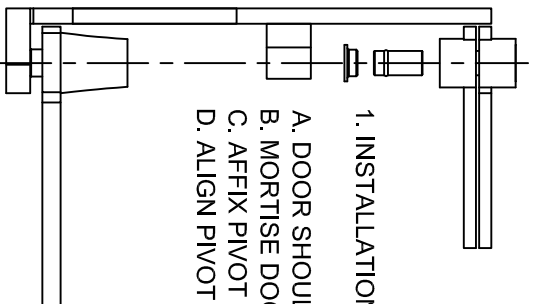
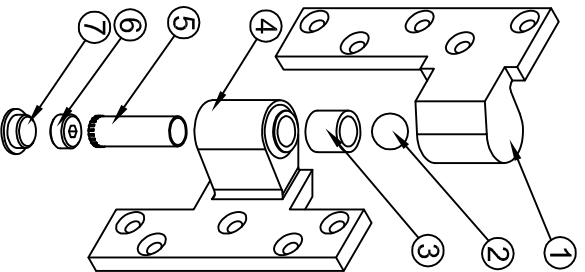

1. INSTALLATION INSTRUCTIONS

- A. DOOR SHOULD ALREADY BE HUNG W/ TOP PIVOT & BOTTOM PIVOT (OR FLOOR CLOSER).
- B. MORTISE DOOR & FRAME PER TEMPLATE ON REVERSE SIDE.
- C. AFFIX PIVOT TO DOOR & FRAME.
- D. ALIGN PIVOT POINT FROM TOP PIVOT TO BOTTOM ARM. (SEE DIAGRAM)

ITEM NO.	QTY.	PART NO.
1	1	019 Door Leaf
2	1	019 Alignment Ball
3	1	019 Needle Bearing
4	1	019 Jamb Leaf
5	1	019 Pivot Pin
6	1	019 Retainer Screw
7	1	019 End Cap

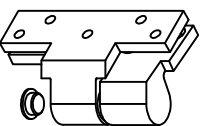

E. REMOVE END CAP (ITEM #7)

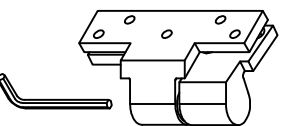

F. TURN RETAINER SCREW (ITEM #6) CLOCKWISE. RAISE THE DOOR TO THE DESIRED HEIGHT.

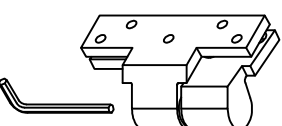

G. TURN RETAINER SCREW (ITEM #6) COUNTERCLOCKWISE TO LOWER DOOR.

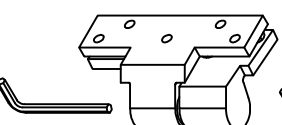

H. TIGHTEN RETAINER SCREW (ITEM #6) UNTIL YOU FEEL RESISTENCE. REPLACE END CAP (ITEM #7).

www.abhmf.com

E-mail: abhinfo@abhmf.com

Architectural Builders Hardware Mfg., Inc.

1222 Ardmore Ave., Itasca, IL 60143

630.875.9900; FAX 800.9FAXABH (932.9224)

© 2007 ABH Mfg., Inc.
printed in USA

019-1.5-2-02.DWG

019-1.5

REVISED 11-30-10

ABH