

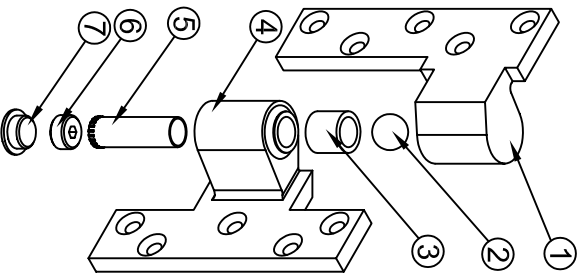

## 019 INTERMEDIATE PIVOT 3/4" OFFSET



ITEM NO.	QTY.	PART NO.
1	1	019 Door Leaf
2	1	019 Alignment Ball
3	1	019 Needle Bearing
4	1	019 Jamb Leaf
5	1	019 Pivot Pin
6	1	019 Retainer Screw
7	1	019 End Cap

IF BOTTOM ARM IS FOR 0117 PIVOT,  
MAKE SURE THE ARM IS SITTING  
ALL THE WAY DOWN ON THE BASE.  
MAKE NO ADJUSTMENT TO THE 019.

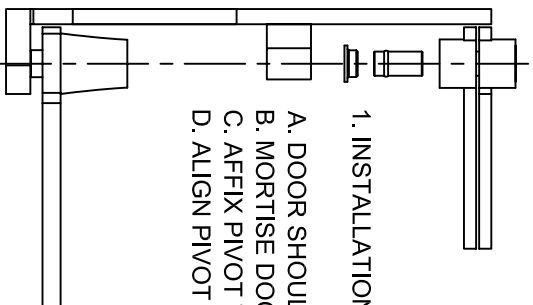
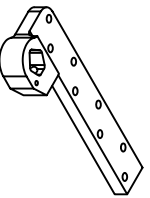

### 1. INSTALLATION INSTRUCTIONS

- DOOR SHOULD ALREADY BE HUNG W/ TOP PIVOT & BOTTOM PIVOT (OR FLOOR CLOSER).
- MORTISE DOOR & FRAME PER TEMPLATE ON REVERSE SIDE.
- AFFIX PIVOT TO DOOR & FRAME.
- ALIGN PIVOT POINT FROM TOP PIVOT TO BOTTOM ARM. (SEE DIAGRAM)

### E. REMOVE END CAP (ITEM #7)

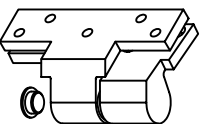

### G. TURN RETAINER SCREW (ITEM #6) COUNTERCLOCKWISE TO LOWER DOOR.

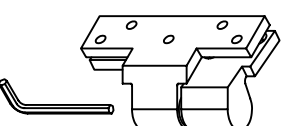

### F. TURN RETAINER SCREW (ITEM #6) CLOCKWISE. RAISE THE DOOR TO THE DESIRED HEIGHT.

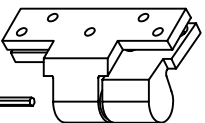

### H. TIGHTEN RETAINER SCREW (ITEM #6) UNTIL YOU FEEL RESISTENCE. REPLACE END CAP (ITEM #7).

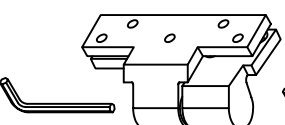

www.abhmfmg.com

E-mail: [abhinfo@abhmfmg.com](mailto:abhinfo@abhmfmg.com)

Architectural Builders Hardware Mfg., Inc.

1222 Ardmore Ave., Itasca, IL 60143

630.875.9900; FAX 800.9FAXABH (932.9224)

©2007 ABH Mfg., Inc.  
printed in USA

019-2-01.DWG

019

REVISED 05-21-07

**ABH**