

0117 3/4" OFFSET PIVOT SET

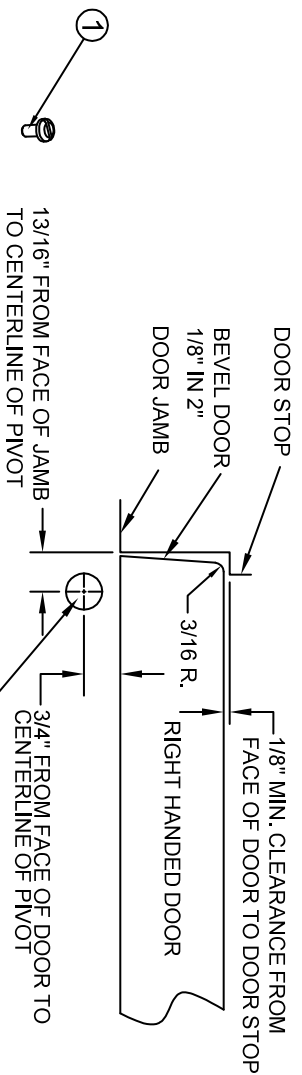

1. INSTALLING PIVOT

- A. MEASURE 3/16" OUT FROM DOOR JAMB.
- B. ALLOW 1/8" MIN CLEARANCE FROM DOOR STOP TO DOOR FACE.
- C. MEASURE DOOR THICKNESS AND ADD 3/4".
- D. WHERE THESE LINES INTERSECT DETERMINES THE CENTERLINE OF THE PIVOT.

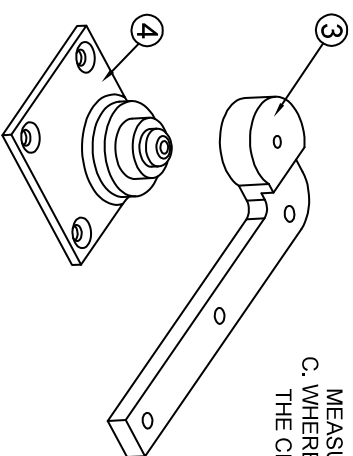

ITEM NO.	QTY.	PART NO.
1	1	0117 COVER SCREW
2	1	0117 ARM COVER
3	1	0117 DOOR PORTION
4	1	0117 FLOOR PORTION

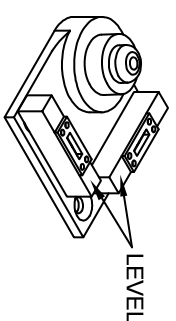

2. SET PIVOT SET

- A. PREPARE FLOOR TO RECEIVE FLOOR PORTION. SET ANCHORS PROVIDED SECURELY IN FLOOR.
- B. IMPORTANT: FLOOR PORTION MUST BE LEVEL. LEVEL IN BOTH DIRECTIONS PER ILLUSTRATION.
- C. FLOOR PORTION SHOULD BE PARALLEL WITH CENTERLINE OF DOOR.

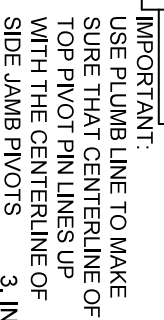

3. INSTALL TOP PIVOT AND PIVOT ARM

- A. INSTALL TOP PIVOT IN DOOR PER TEMPLATE.
- B. INSTALL TOP PIVOT IN FRAME PER TEMPLATE.
- C. INSTALL ARM IN DOOR PER TEMPLATE.
- D. CENTERLINE OF TOP PIVOT SHOULD LINE UP WITH CENTERLINE OF PIVOT ARM. (USE PLUMB LINE AS ILLUSTRATED)
- E. IF SIDE JAMB PIVOT IS USED. SEE REQUIRED TEMPLATE.

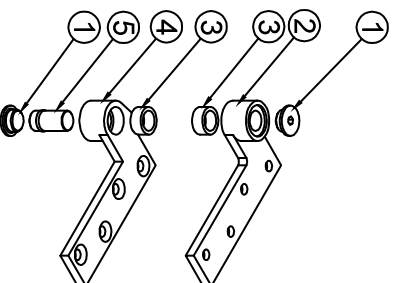

ITEM NO.	QTY.	PART NO.
1	2	0180 END CAP
2	1	0180 JAMB PORTION
3	2	0180 NEEDLE BEARING
4	1	0180 DOOR PORTION
5	1	0180 PIVOT PIN

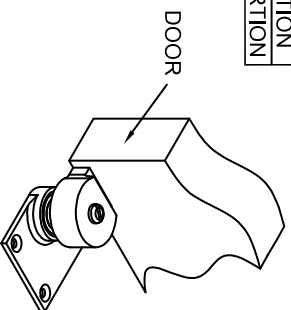

4. HANG DOOR

- A. SET DOOR ON PIVOT SET SPINDLE.
- B. PUSH TOP PIVOT PIN IN PLACE AND TIGHTEN 0180 END CAP (ITEM #1).
- C. PUT ARM COVER (ITEM #2) ON AND SECURE TIGHTLY WITH COVER SCREW.

NOTE:
AFTER TOP PIVOT INSTALLATION IS COMPLETE ITEM #1 (END CAP) MUST BE TIGHTENED SECURELY.

www.abhmf.com

E-mail: abhinfo@abhmf.com

Architectural Builders Hardware Mfg., Inc.

1222 Ardmore Ave., Itasca, IL 60143

630.875.9900; FAX 800.9FAXABH (932.9224)

© 2008 ABH Mfg., Inc.
printed in USA

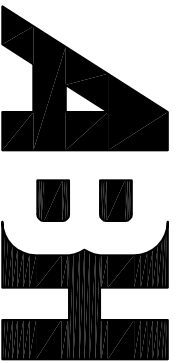

0117

REVISED 10-03-08

0117-2-03.DWG